



THIN SHEET NUT-INSERT

MATERIAL : LOW CARBON STEEL (AK SERIES)

FINISH : ZINC CLEAR CR III

SMALL FLANGE

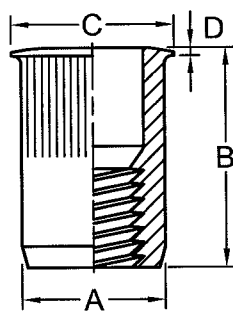

LARGE FLANGE

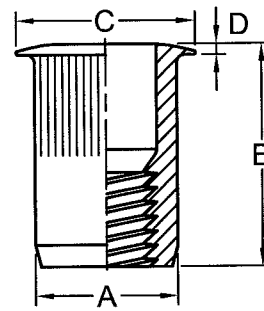

SMALL FLANGE

METRIC DIMENSIONS (mm)

THREAD SIZE	ITEM NO.	A +0.05 / -0.15	B ±0.40	C ± 0.30	D ± 0.1	GRIP RANGE	HOLE +0.1
M4 x 0.7	AK SM4	6.70	11.10	7.85	0.50	0.5 ~ 2.0	6.75
	AK SM4-L		12.40			2.0 ~ 3.3	
M5 x 0.8	AK SM5	7.50	12.50	8.65	0.50	0.5 ~ 3.3	7.60
	AK SM5-L		15.30			3.3 ~ 5.7	
M6 x 1.0	AK SM6	9.90	15.30	11.60	0.55	0.7 ~ 4.2	10.00
	AK SM6-L		17.80			4.2 ~ 6.6	
M8 x 1.25	AK SM8	13.45	18.00	15.10	0.55	0.7 ~ 3.8	13.50
	AK SM8-L		21.00			3.8 ~ 7.9	
M10 x 1.50	AK SM10	13.45	18.00	15.10	0.55	0.7 ~ 3.8	13.50
	AK SM10-L		21.00			3.8 ~ 7.9	

LARGE FLANGE

METRIC DIMENSIONS (mm)

THREAD SIZE	ITEM NO.	A +0.05 / -0.15	B ±0.40	C ± 0.30 *± 0.64	D ± 0.1	GRIP RANGE	HOLE +0.1
M4 x 0.7	AK LM4	6.70	11.45	9.90	0.75	0.5 ~ 2.0	6.75
	AK LM4-L		12.70			2.0 ~ 3.3	
M5 x 0.8	AK LM5	7.50	12.85	10.55	0.75	0.5 ~ 3.3	7.60
	AK LM5-L		15.50			3.3 ~ 5.7	
M6 x 1.0	AK LM6	9.90	15.50	12.70	0.75	0.7 ~ 4.2	10.00
	AK LM6-L		18.00			4.2 ~ 6.6	
M8 x 1.25	AK LM8	13.45	18.40	*17.40	0.90	0.7 ~ 3.8	13.50
	AK LM8-L		21.35			3.8 ~ 7.9	
M10 x 1.50	AK LM10	13.45	18.40	*17.40	0.90	0.7 ~ 3.8	13.50
	AK LM10-L		21.20			3.8 ~ 7.9	

The inch size (thread) is available